

## Yale University Library Digital Collections

<b>Title</b>	Map of Oak Park addition to McMinnville, Oregon.
<b>Date</b>	1889?]
<b>Rights</b>	The use of this image may be subject to the copyright law of the United States (Title 17, United States Code) or to site license or other rights management terms and conditions. The person using the image is liable for any infringement
<b>Container information</b>	BRBL_00622
<b>Generated</b>	2021-03-02 17:34:08 UTC
<b>Terms of Use</b>	<a href="https://guides.library.yale.edu/about/policies/access">https://guides.library.yale.edu/about/policies/access</a>
<b>View in DL</b>	<a href="https://collections.library.yale.edu/catalog/15821588">https://collections.library.yale.edu/catalog/15821588</a>

---

MAP OF OAK PARK ADDITION TO McMINNVILLE OREGON

SCALE: AS SHOWN TO 1 INCH

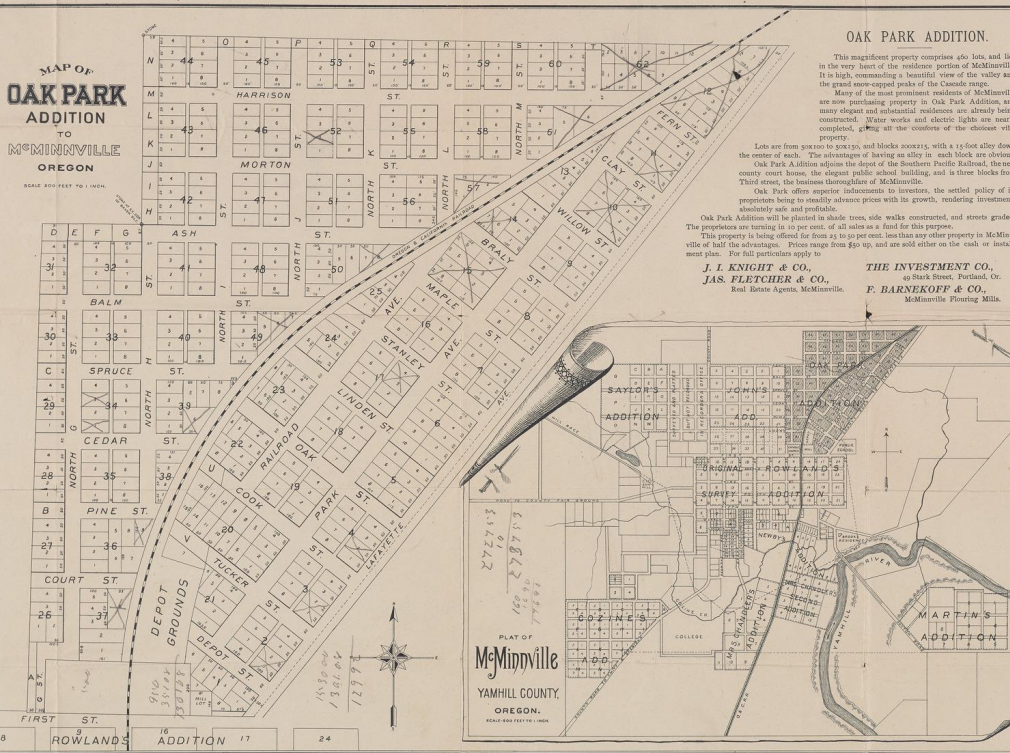

OAK PARK ADDITION.

This magnificent property comprises 450 lots and lies in the very heart of the residence portion of McMinnville. It is high, commanding a beautiful view of the valley and the great snow-capped peaks of the Cascade range.

Many of the most prominent residents of McMinnville are now purchasing property in Oak Park Addition, and many elegant and substantial residences are already being constructed.

Oak Park Addition adjoins the depot of the Southern Pacific Railroad, the new county court house, the elegant public school building, and is three blocks from Third street, the business thoroughfare of McMinnville.

Oak Park offers superior inducements to investors, the settled policy of its proprietors being to steadily advance prices with its growth, rendering investments absolutely safe and profitable.

Oak Park Addition will be planted in shade trees, side walks constructed, and streets graded. The propositions are turning in 10 per cent. of all sales as a fund for this purpose.

This property is being offered for from 25 to 50 per cent. less than any other property in McMinnville of half the advantages. Prices range from \$50 up, and are sold either on the cash or installment plan. For full particulars apply to:

J. I. KNIGHT & CO., THE INVESTMENT CO., JAS. FLETCHER & CO., F. BARNERKOFF & CO., Real Estate Agents, McMinnville, McMinnville Flouring Mills.

A Few Facts About McMinnville.

The wonderful growth of McMinnville in a few years, and its position of a fine location in regard to the mountains and the river, has attracted the attention of the world.

A Great Railroad Center. McMinnville is situated in a location for transportation facilities. It is situated on the main line of the Southern Pacific Railroad, and is one of the best locations for a railroad center in Oregon.

The Magnificent Country and Healthful Resources. The country for miles around McMinnville is naturally well adapted for the raising of crops. The soil is fertile, and the climate is healthy.

The County Seat of the Richest County in Oregon. The county seat of the richest county in Oregon is McMinnville. The county is rich in resources and has a fine location for a city.

Her Many Successful Manufacturing Industries. McMinnville has many successful manufacturing industries. The city is well situated for the raising of crops and the raising of stock.

Banking Facilities. McMinnville has good banking facilities, and the post office is one of the best in the county.

Schools and Churches. McMinnville has good schools and churches. The city is well situated for the raising of crops and the raising of stock.

Used Water Power. Baker creek furnishes McMinnville with a fine water power, that is not being used. It is 17 feet high, and can be increased.

Schools and Churches. McMinnville has good schools and churches. The city is well situated for the raising of crops and the raising of stock.

Used Water Power. Baker creek furnishes McMinnville with a fine water power, that is not being used. It is 17 feet high, and can be increased.

Schools and Churches. McMinnville has good schools and churches. The city is well situated for the raising of crops and the raising of stock.

Used Water Power. Baker creek furnishes McMinnville with a fine water power, that is not being used. It is 17 feet high, and can be increased.

Schools and Churches. McMinnville has good schools and churches. The city is well situated for the raising of crops and the raising of stock.

Used Water Power. Baker creek furnishes McMinnville with a fine water power, that is not being used. It is 17 feet high, and can be increased.

PLAT OF McMinnville YAMHILL COUNTY, OREGON.

\*846 Mc228 1827